

PMT060/□□□

Manuale / Hand Operated

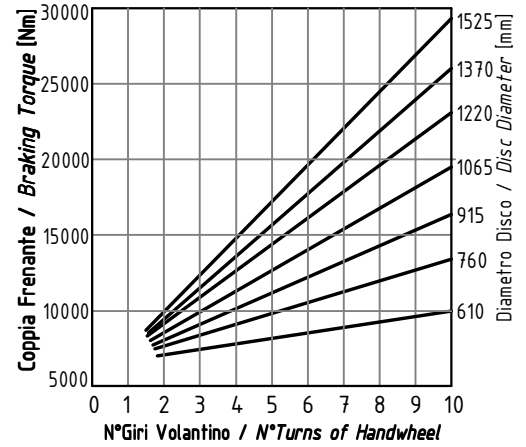
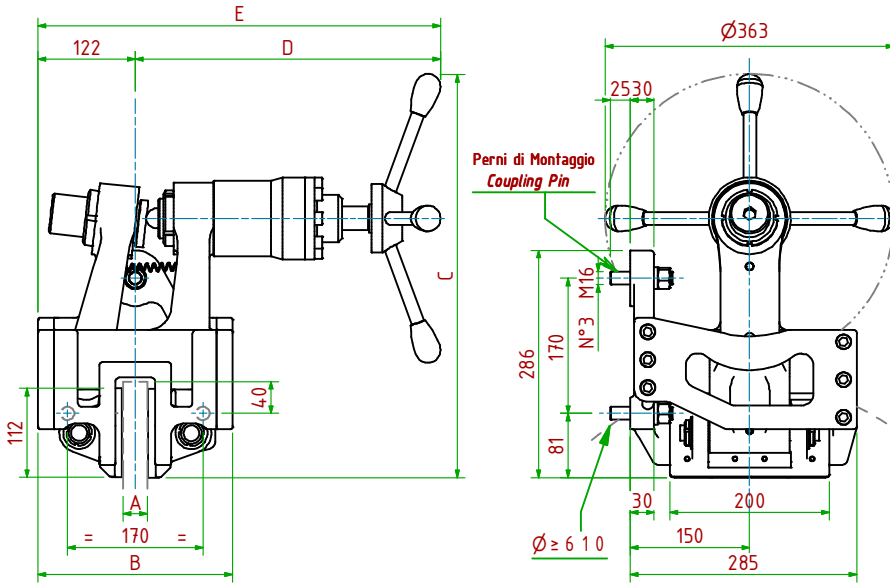

- Coppia Frenante/Braking Torque: $Md = [Ft \times (\Phi(m) / 2 - 0.065(m))]$
Importante: La Coppia Frenante Iniziale può essere più bassa del 30%-50% **Warning:** Initial Braking Torque can be lower of 30%-50%
- Usura Ferodi Massima Totale/Maximum total wear of pads =12mm

MODELLO/MODEL	CODICE/ CODE	A	B	C	D _{Max}	E _{Max}	Forza Frenante/Braking Force	Peso
PMT060/25.4	19.06.060.04	25.4	244	507	384	506	Ft= 41800N (10Giri)	62.5kg
PMT060/ 30	19.06.060.05	30	244	507	384	506	Ft= 41800N (10Giri)	62.5kg
PMT060/ 40	19.06.060.06	40	244	507	389	511	Ft= 41800N (10Giri)	62.5kg



PMTP600/□□□

Manuale / Hand Operated

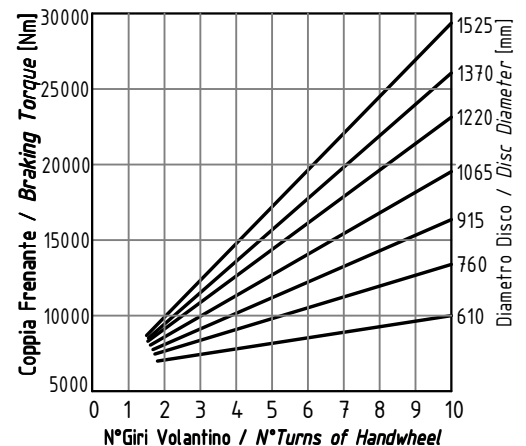
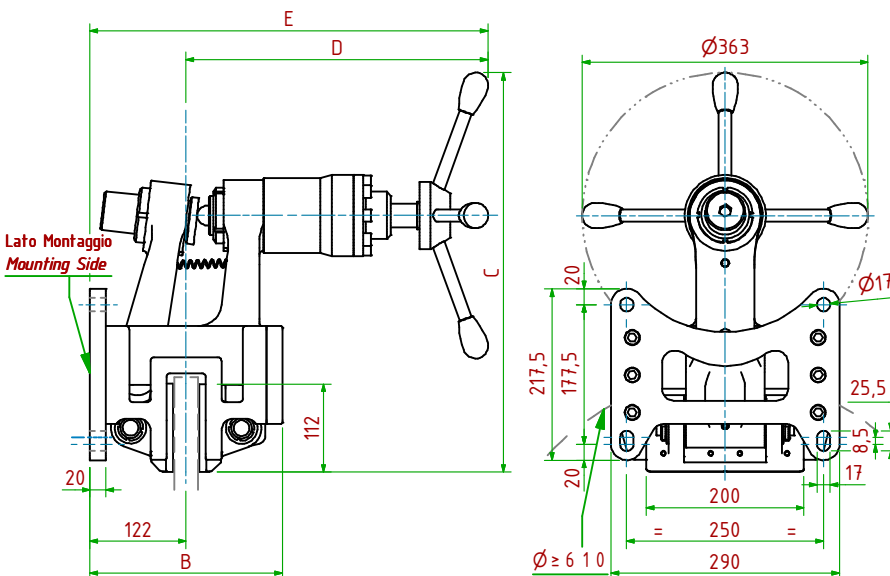

- Coppia Frenante/Braking Torque: $Md = [Ft \times (\Phi(m) / 2 - 0.065(m))]$
Importante: La Coppia Frenante Iniziale può essere più bassa del 30%-50% **Warning:** Initial Braking Torque can be lower of 30%-50%
- Usura Ferodi Massima Totale/Maximum total wear of pads =12mm

MODELLO/MODEL	CODICE/ CODE	A	B	C	D _{Max}	E _{Max}	Forza Frenante/Braking Force	Peso
PMTP600/25.4	19.06.600.04	25.4	244	507	384	506	Ft= 41800N (10Giri)	60.0kg
PMTP600/ 30	19.06.600.05	30	244	507	384	506	Ft= 41800N (10Giri)	60.0kg
PMTP600/ 40	19.06.600.06	40	244	507	389	511	Ft= 41800N (10Giri)	60.0kg

